

Beamforming Microphone Array Ceiling Tile Conduit Box Installation

INCLUDED PARTS:

- 1 Conduit box with 6x concentric ½" & ¾" knockouts
- 1 Conduit box lid
- 4 M4x8mm screws

Important: It is recommended that conduit box be attached before BMA CT unit is placed into ceiling grid

Step 1 Remove adhesive tape liner from bottom three surfaces of conduit box to expose adhesive strips. This adhesive is rated for high temperatures.

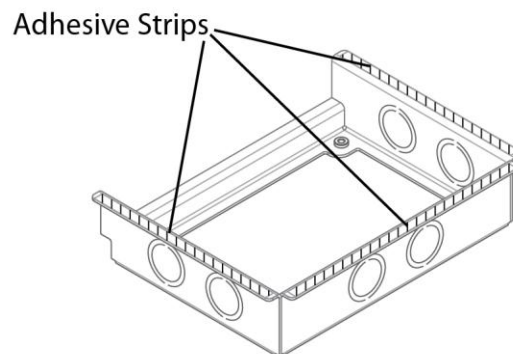

Step 2 Tilt conduit box to avoid prematurely engaging adhesive, while aligning open end of conduit box to BMA CT connectors and sliding into position against the self-clinching nuts. Press into place.

USE SELF-CLINCHING NUT
TO POSITION CONDUIT BOX

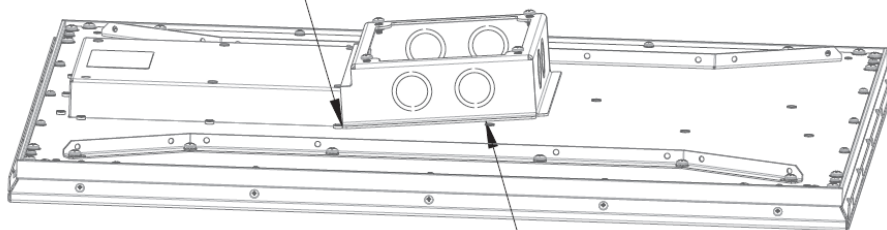

KEEP CONDUIT BOX TILTED
UNTIL POSITIONED PROPERLY
TO AVOID TAPE ENGAGING PREMATURELY

Step 3 If not already done, remove conduit box lid to attach conduit and route cables (not included) through desired knockout

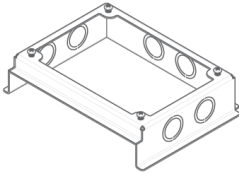

Step 4 Place lid on conduit box and tighten screws

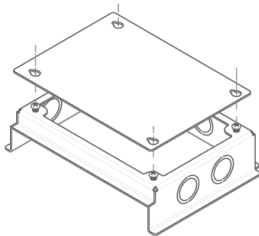

EXAMPLE WIRING CONFIGURATION:

(conduit attachments, cable routing, and configurations may vary)

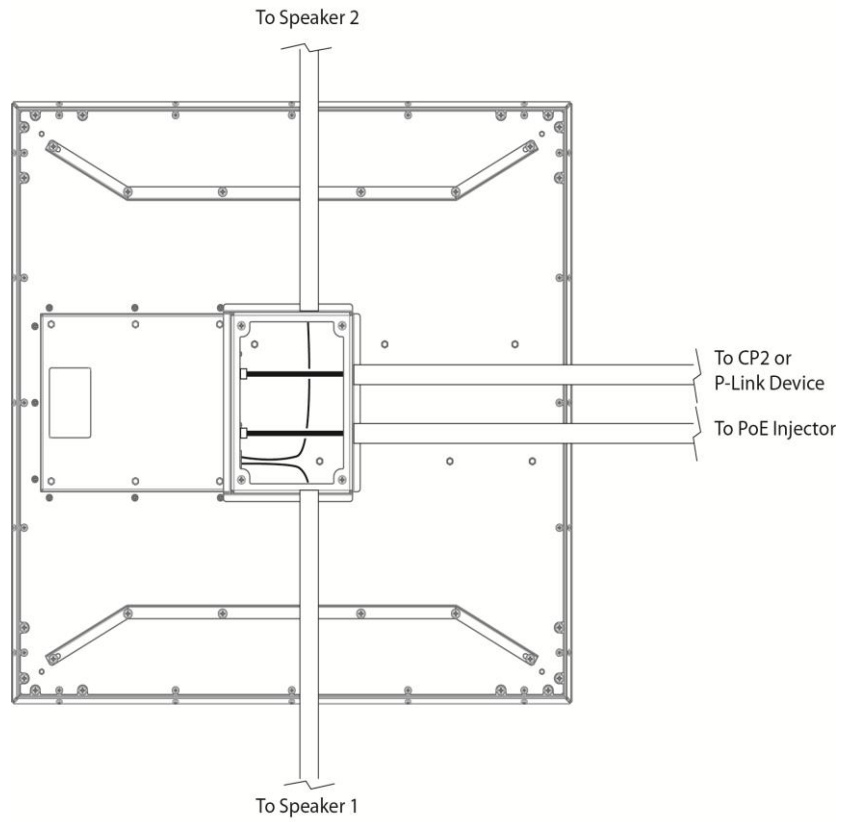

CLEARONE CONTACTS

HEADQUARTERS:

Salt Lake City, UT USA

5225 Wiley Post Way
Suite 500
Salt Lake City, UT 84116

Sales: 800.707.6994

Toll Free: 800.945.7730

EUROPE:

Tel: 800.238.5936, Option 2

e-mail: emea.support@clearone.com

MIDDLE EAST:

Tel: 800.238.5936, Option 2

e-mail: emea.support@clearone.com

INDIA:

Tel: 1-801-974-3760, Option 2

1-800-283-5936, Option 2

e-mail: india.support@clearone.com

OTHER REGIONS:

Tel: +1.801.975.7200

e-mail: global@clearone.com